

ENTRY METHOD: FIRST RECEIVED

ENTRIES WILL OPEN June 17, 2016 at 8:00 a.m. at the Trial Secretary's address. All entries received before this date will be returned. Overnight or certified mail must be sent with the "No Signature Required" waiver signed.

ENTRIES CLOSE ON August 26, 2016 at 6:00 p.m.(Minimum of 14 days prior to the start of the trial) after which time entries cannot be accepted, cancelled, altered, or substituted except as provided for in Chapter 11, Section 6 of the Rules Applying to Dog Shows. Envelopes/transactions containing entries for more than the ten (10) dog maximum and/or entries received prior to the opening date shall be treated as an invalid entry and shall be returned to the sender.

PREMIUM LIST  
AKC All-Breed AGILITY TRIALS  
Open to All AKC-Recognized Breeds and  
All-American Dogs/Mixed Breed Dogs Listed  
in the AKC Canine Partners Program<sup>SM</sup>

### Peoria Obedience Training Club



Licensed by the American Kennel Club

**Sept. 9, 2016** Event # 2016014006  
**Sept. 10, 2016** Event # 2016014007  
**Sept. 11, 2016** Event # 2016014008

### Avanti's Dome & Sports Center

3401 Griffin Avenue  
Pekin, IL 61554

#### ENTRY LIMITS

Friday, Saturday & Sunday – 330 runs per judge for a total of 660 runs per day

Indoors on Soccer Turf – both rings are 110x110

**RUBBERIZED CONTACTS IN BOTH RINGS**

**Trial Hours:** Friday, Saturday & Sunday – 7:00 am to one hour after last run

#### Judges:

Diane D Fyfe #9369, VMO  
Richard T Fyfe #90093

#### CERTIFICATION

Permission is granted by the American Kennel Club for the holding of this event under American Kennel Club rules and regulations.

James P. Crowley, Secretary



### OFFICERS OF THE PEORIA OBEDIENCE TRAINING CLUB

President.....Paul Mooney  
Secretary.....Jill Williamson  
Vice President.....Sande Wilkie  
Treasurer.....Deyonne Hinderliter

#### TRIAL CHAIRPERSON

Sande Wilkie  
1741 Knox Road 1950 East  
Victoria, IL 61485-9541  
309-339-9633 cell, 309-639-4477 home  
[s.wilkie09@gmail.com](mailto:s.wilkie09@gmail.com)

#### TRIAL SECRETARY

Le Hayes  
10800 W. Brimfield Jubilee Road  
Princeville, IL 61559  
309-243-8652  
[LeHayes3@aol.com](mailto:LeHayes3@aol.com)

#### EVENT COMMITTEE

Diane Bader, Linda Doerfler, Vickie Gordon, Paul & Peggy Mooney,  
Jack & Sande Wilkie  
Hospitality ... Nancy Affolter  
Public Relations ... Linda Locke

#### JUDGES AND ASSIGNMENTS

Diane Fyfe, #90369, VMO  
101 Retriever Drive  
Pikeville, Tn, 36367  
Friday – Ring 2  
Saturday - Ring 1  
Sunday - Ring 2  
Richard Fyfe, #90093  
101 Retriever Drive  
Pikeville, Tn, 36367  
Friday – Ring 1  
Saturday Ring 2  
Sunday Ring 1

#### VETERINARIAN ON CALL (OR IN ATTENDANCE)

Tri-County Animal Emergency Clinic  
1800 N Sterling Ave  
Peoria, IL 61604  
309-672-1565

#### EMERGENCY SERVICES

Tazwell County 911

#### CLASSES OFFERED AND START TIMES

##### Friday, Saturday and Sunday

|                                  |                             |
|----------------------------------|-----------------------------|
| <b>Ring One</b>                  | <b>Ring Two</b>             |
| FAST – Master and Excellent      | FAST – Novice and Open      |
| Standard – Premier               | JWW – Novice through Master |
| Standard – Master through Novice | Premier JWW                 |
|                                  | T2B                         |

**Judging to begin at 8 a.m in Ring 1 and 8:30 in Ring 2**

Please consult the AKC Regulations for Agility Trials for a complete description and eligibility for entry into these classes. The exhibitor is fully responsible for entering the dog in the correct class(es)/height divisions. Dogs running in a lower height division than they are eligible for will be eliminated.

## HEIGHT DIVISIONS

| REGULAR  | PREFERRED  | HEIGHT AT WITHERS  |
|--|--|--|
| Handlers may opt to run their dog in a higher height division. | Handlers must run their dog in their proper eligible height. | Owners are responsible for entering their dog in the proper height division. |
| 8"   | 4"   | For dogs 11 inches and under at the withers                                  |
| 12"  | 8"   | For dogs 14 inches and under at the withers                                  |
| 16"  | 12"  | For dogs 18 inches and under at the withers                                  |
| 20"  | 16"  | For dogs 22 inches and under at the withers                                  |
| 24"  | 20"  | For dogs over 22 inches at the withers                                       |
| 26"  | n/a  | Dogs may be entered at this height at their owner's discretion               |

### MEASURING and HEIGHT CARD INFORMATION

Effective January 1, 2010, exhibitors are no longer required to provide proof to Trial Secretaries that their dog has a valid jump height card as part of the check-in process. Furthermore, this change eliminates the need for a copy of the jump height card to be submitted with an entry form. Dogs without a valid Jump Height Card/Form may still compete; but they must be measured/wicketed by the **Judge of Record** PRIOR to running in their class and this measurement will be valid for that weekend of trials only. The exception to this requirement is a dog entered in the 24" or 26" height division. However, if a **Volunteer Measuring Official (VMO)** or an **Agility Field Rep** is present; ALL dogs without a valid Jump Height Card/Form must be measured at some time during the trial or cluster of trials. This does not preclude having the dog wicketed by the Judge of Record if the VMO or Rep is not available to measure the dog **before** its first run of the trial or cluster of trials. It is the exhibitor's responsibility to have their dog measured prior to running and failure to do so will result in the cancellation of any qualifying scores. There will be a VMO at this trial

### NEW Simplified Jump Height Card Process

When filling out the entry form, there is a new section at the top of the form for exhibitors to designate whether your dog needs to be officially measured. Please check the box so that the Trial Secretary knows whether to include your dog on the *Dogs To Be Measured List*. It is no longer required that you submit a copy of your dog's jump height card with your entry form or show it during day of show check-in; although exhibitors are required to have the official form/card with them at the trial to present upon request.

### DOG ELIGIBLE TO ENTER

This trial is open to all dogs fifteen (15) months of age or older that are registered with the American Kennel Club or that have AKC Limited Registration, Purebred Alternative Listing/Indefinite Listing Privileges (PAL/ILP), an AKC Canine Partners listing number, or approved Foundation Stock Service (FSS) breeds are eligible to participate.

Dogs with a Purebred Alternative Listing/Indefinite Listing Privileges (PAL/ILP) or an AKC Canine Partners listing number must be spayed or neutered in order to compete. Wherever the word "dog" is used in these regulations it includes both sexes.

Dogs should be physically sound. Dogs that are blind or deaf shall not be eligible, and neither are bitches in season, aggressive dogs, or dogs suffering from any deformity, injury, or illness which may affect the dog's physical or mental performance. No dog shall compete if it is taped or bandaged in any way or has anything attached to it for medical purposes. Refer to Chapter 2 of the Registration and Discipline Rules for the listing of registerable breeds that may participate. Puppies under four (4) months of age are strictly prohibited from the trial grounds.

**All exhibitors should obtain a copy of the Regulations for Agility Trials by downloading them from the American Kennel Club website at <http://www.akc.org/rules/>.**

## OBSTACLES AND RING CONDITIONS

All obstacles will meet the specifications for obstacles in the current edition of the AKC Regulations for Agility Trials. **Rubber contacts will be used for all classes in both Rings.** All classes will take place **indoors** on Soccer turf. Ring size will be 110 x 110. This site is air-conditioned and heated.

### ENTRY FEES PER DAY

|   |         |
|---|---------|
| First entry of each dog (includes a \$3.50 AKC recording fee)   | \$25.00 |
| Second entry of same dog (includes a \$3.00 AKC recording fee)  | \$15.00 |
| Third entry of same dog (includes a \$3.00 AKC recording fee)   | \$15.00 |
| Fourth entry of same dog (including a \$3.00 AKC recording fee) | \$15.00 |

If you would like to know the status of your entry prior to the issuance of the judging schedule upon closing, please enclose a self-addressed, stamped envelope or postcard along with your entry. E-mail confirmations will be sent to those listing a legible e-mail address on the entry form.

**Mail entry forms and fees to:** Le Hayes, Trial Secretary, 10800 W Brimfield Jubilee Road, Princeville, IL 61559, 309-243-8652. Please make checks payable to **POTC**. No entries will be accepted by phone, or fax. or hand delivery. Express mail entries must include the signature waiver allowing them to be left at the secretary's address. Inquiries may be directed to Le Hayes at [lehayes3@aol.com](mailto:lehayes3@aol.com). No entry shall be made and no entry shall be accepted which specifies any conditions as to its acceptance.

**Illegible entries** will not be processed and will be returned to the exhibitor. Returned checks do not constitute a valid entry and the Treasurer will add a \$20 collection fee to the amount of each returned check.

Peoria Obedience Training Club is accepting online entries through [www.labtestedonline.com](http://www.labtestedonline.com). During the first 48 hours after opening, the initial limit of entries designated as either online or paper will be as follows: Online entries: 220; Paper entries: 440. If either form of entry has not filled at the end of the 48 hour time period, the club reserves the right to decrease or increase either the online or paper limit accordingly. No hand deliveries will be accepted in the first twenty-four hours following the opening date and time.

### COURSE WALK-THROUGHS AND WARM-UP INFORMATION

Handlers in all classes are permitted to walk the course, without a dog, during a walk-through period held prior to the start of the class. The walk-through is restricted to handlers entered in that class only. Handlers with multiple dogs, at events with multiple rings may request to walk with a height group other than the one their dog is entered in if a conflict is imminent.

A warm-up area, consisting of a regulation agility jump, may be provided for exhibitors. The warm-up area is to be used exclusively for warming up the dog and not for training or relieving of the dog.

### RIBBONS AWARDS AND PRIZES

Rosettes will be awarded in each jump height division in each class as follows:

|                       |            |
|-----------------------|------------|
| First Place.....      | Blue       |
| Second Place.....     | Red        |
| Third Place.....      | Yellow     |
| Fourth Place.....     | White      |
| Qualifying Score..... | Dark Green |

A New Title rosette will be awarded to all dog and handler teams finishing a title. A MACH & PACH rosette and decorated MACH or PACH bar will be awarded to all dog and handler teams that attain their MACH or PACH. Cones will be presented to those dogs attaining their MX/MXP/MXJ/MJP. **One dog toy, valued at three to five dollars, will be given to each dog entered per weekend.**

A PAX rosette will be awarded for those achieving their PAX and title cones will be awarded for those receiving their MX, MXJ, MXP or MJP.

## NOTICE TO EXHIBITORS

### SAFETY, BEHAVIOR and LIABILITY

**The safety of the dog** is our primary concern. By entering this trial, exhibitors acknowledge that they are familiar with the rules and regulations of this sport, and that their dogs are familiar with and able to perform all obstacles safely.

**It is expressly understood** that exhibitors alone are responsible for the behavior of their dogs and/or children. Any exhibitor whose dogs and/or children create an unnecessary disturbance or repeatedly engage in unsafe or disruptive behavior may, at the discretion of the event committee, be asked to leave the show site. In such case, no refund of any fees paid will be made. The Peoria Obedience Training Club (POTC), Avanti's Dome and Sports Center and its agents, employees, etc., will assume no responsibilities for any loss, damage or injury sustained by exhibitors or handlers, or to any of their dogs or property and further assumes no responsibility for injury to children. The Peoria Obedience Training Club reserves the right to decline entries for cause and may remove any dog on account of aggression. No one shall have any recourse or claim against the POTC or any official thereof.

**All dogs must be on leash** at all times when on trial grounds except when in the designated warm-up area or competing on the course.

### REFUNDS

**No entry fee** will be refunded if the trial cannot open or be completed by reason of riots, civil disturbances, fire, an act of God, public emergency, act of a public enemy, or any other cause beyond the control of the organizing committee. No entry fee will be refunded in the event a dog is absent, disqualified, excused, or barred from competition by the action of the Event Committee.

**Bitches in season** are not permitted to compete in Agility Trials. As such, the club will refund the full amount of the entry fee paid for bitches and unable to compete for this reason upon presentation of a veterinarian certificate. This certificate must be presented to the Trial Secretary prior to the start of judging on the first day of the trial or cluster of trials.

### RINGSIDE

**Dogs may arrive** any time prior to judging if the dog has a valid temporary or permanent jump height card. Otherwise, they must be available for measuring prior to the start of their class if a VMO or AKC Field Rep is available to measure dogs. All dogs not needed for further judging will be excused.

**Judges are not required** to wait for dogs. The Owner of each dog is solely responsible for having it ready at ringside when it is to be judged. The Club has no responsibility for providing service through a public address system or stewards or runners for the purpose of calling or locating dogs that are not brought into the ring when required.

### CATALOGS

**Advance catalog sales** may be ordered and prepaid on your entry form for \$6.00. A limited number of catalogs will be available for sale at the trial site for a cost of \$8.00. Running order sheets will be available to all exhibitors at no charge.

## ADDITIONAL SITE INFORMATION

**Crating space:** Ample crating will be directly behind the agility rings however, POTC and the Avanti's Dome will not be responsible for any lost or damaged items left at the show site. You can bring in your equipment through the back overhead door entrance. Those doors are to be operated by Avanti's personnel **only**. Front entry through revolving door throughout the day.

**A full service food concession** is available on the site. The Sports Arena asks that no food be brought into the facility. Dog treats are allowed. There are several restaurants and fast food vendors within a 3 miles driving distance. Food will be provided for all trial helpers.

**Overnight or RV Parking** is available. **PLEASE NOTE:** There is **no electrical service for large motor homes** at this facility. RV parking is not restricted to a particular area. Showers are not available onsite.

**Exhibitors are responsible** for cleaning up after their dog(s). Any exhibitor failing to do so may be excused without benefit of refund if the Event Committee deems the exhibitor to be in violation of this requirement. Cleaning supplies and disposal sites will be available at various locations around the show grounds.

Special arrangements can be made with Sande Wilkie @ [s.wilkie09@gmail.com](mailto:s.wilkie09@gmail.com) to set up on Thursday, Sept. 8 2016. You must contact her to make arrangements.

The building will be open to exhibitors 6:30 am Friday 9/9/16, Self-service check in will begin at 7:00 all days. Class judging will begin no earlier than 8:00 AM. **Exact running order will be determined after entries close and will be provided in the Judging Program.** There will be one half hour difference in star time between rings. This set of trials uses electronic timers.

Entries will not be accepted without signature, fees and back of entry form with agreement signed, nor will credit cards or faxed entries be accepted. Online entries at [www.LabTestedOnline.com](http://www.LabTestedOnline.com) are accepted.

POTC and Avanti's Dome & Sports Center will not be responsible for the loss of or damage to any dog exhibited, or for possessions of any exhibitor, whether the result of an accident or any other cause. It is distinctly understood that every dog at this show is in the care and custody of its owner or handler during the entire time the dog is in the trial buildings or on the grounds of the Avanti's Dome & Sports Center. The welfare of an exhibitor's child is assumed to be the responsibility of the exhibitor. It is distinctly understood that exhibitors will exercise control and restraint over their children.

Exhibitors should follow their veterinarian's recommendations to assure their dogs are free of internal and external parasites, any communicable diseases and have appropriate vaccinations.

Exhibitors may wear shirts or insignia of their training group.

## HOTEL INFORMATION

*These hotels have graciously agreed to accept our well-mannered dogs. A pet deposit may be required. Please check with hotels for policies and restrictions when making reservations. **Please tell them you are with the agility trial at Avanti's Dome with POTC.***

## PEKIN AREA MOTELS

We have arranged for a block of rooms at both facilities. Please reserve a room at least 2 weeks prior to arrival. Be sure to tell them you are going to the dog show at the Dome.

### Super 8 \* new listing

3830 Kelly Drive  
Pekin, IL 61554  
Room rate - \$65.59/day  
\$10 dog fee per stay

### ECONO LODGE SUITES

3242 Vandever Avenue  
Pekin, IL 71554  
309-353-4047  
\$20 for up to 5 dogs per room if  
you mention POTC

### CONCORDE INN

2601 Court Street  
Pekin, IL 61554  
309-347-5533  
\$10 per dog. If 10 rooms are used; the pet  
fee will be waived

## Morton Area Motels (North) I-155 to I-74 East

Approximately 15 miles

Travelodge Morton, Illinois  
101 E Ashland Street  
Morton, IL 61550  
309-266-1600  
Pet fee \$5 per dog – non-  
refundable. Tell them at you are  
with the dog show and spoke with  
the manager

Quality Inn  
115 E. Ashland Street  
Morton, IL 61550  
309-266-8310 -Exit 102 off I-74  
Pet fee \$5 per dog – non-  
refundable. Tell them at you are  
with the dog show and spoke with  
the manager

Americas Best Value Inn  
150 W Ashland St,  
Morton, IL 61550  
309) 266-9933  
\$10 per dog per night, no size limit

## RV CAMPING INFORMATION

|   |  |  |
|---|--|--|
| Carl Spindler Marine &<br>Campground<br>Marina Lane<br>East Peoria, IL 61611<br>309-699-35499 | Kamp Komfort RV Park<br>21408 N 600 East RD<br>Carlock, IL 61725<br>309-376-4411 | Yogi Bear's Jellystone Park<br>Goodfield, IL<br>309-965-2224 |
|---|--|--|

## DIRECTIONS TO THE TRIAL SITE

See Map Next Page

**From the South, St. Louis, MO/Springfield, IL:** Merge onto I-55 N toward CHICAGO., Keep Left to take I-155 N via EXIT 127 toward PEORIA/HARTSBURG, Take the IL-9 Exit/Exit 25, toward Pekin/Bloomington., Turn LEFT onto State Route 9/IL-9. Turn right onto Barney Ave., Take 2<sup>nd</sup> right onto Griffin Ave., Dome will be on Left. Look for "Agility" signs.

**From the North, Chicago/Wisc.:** Take I-55 south. At exit 163 merge onto I-74 W toward Peoria. Take Exit 101 to merge onto I-155-S toward Lincoln. Take the Broadway Rd exit, Exit 28, Turn Right onto Broadway Rd. Broadway Rd becomes Broadway St., Turn Left onto Veterans Dr, Turn right onto Court Street / Il-9, Turn right onto Barney Ave., Take 2<sup>nd</sup> right onto Griffin Ave., Dome will be on Left. Look for "Agility" signs.





AMERICAN KENNEL CLUB

**AGILITY TRIAL MOVE-UP FORM**

(Do not send this form to AKC. Send it to the Trial Secretary)

**USE THIS FORM TO MOVE UP TO A HIGHER AGILITY CLASS ONLY**

It is the option of the club to allow day-to-day move-ups. Exhibitors should refer to a club's premium list to verify the club's policy for moving a dog up. If offered, dogs shall be moved up to a higher class at the request of the owner, as a result of the dog qualifying for an agility title.

The request for moving up must be made to the Trial Secretary on or before 6:00 p.m., Monday, September 5, 2016 or 30 minutes before close of trial Friday and Saturday. All move-up entries are subject to availability of the class and payment of any difference in entry fee. Dogs so moved-up will be entered at the end of the running order. Refer to Chapter 1, Section 20 of the Regulations for Agility Trials for additional move-up requirements.

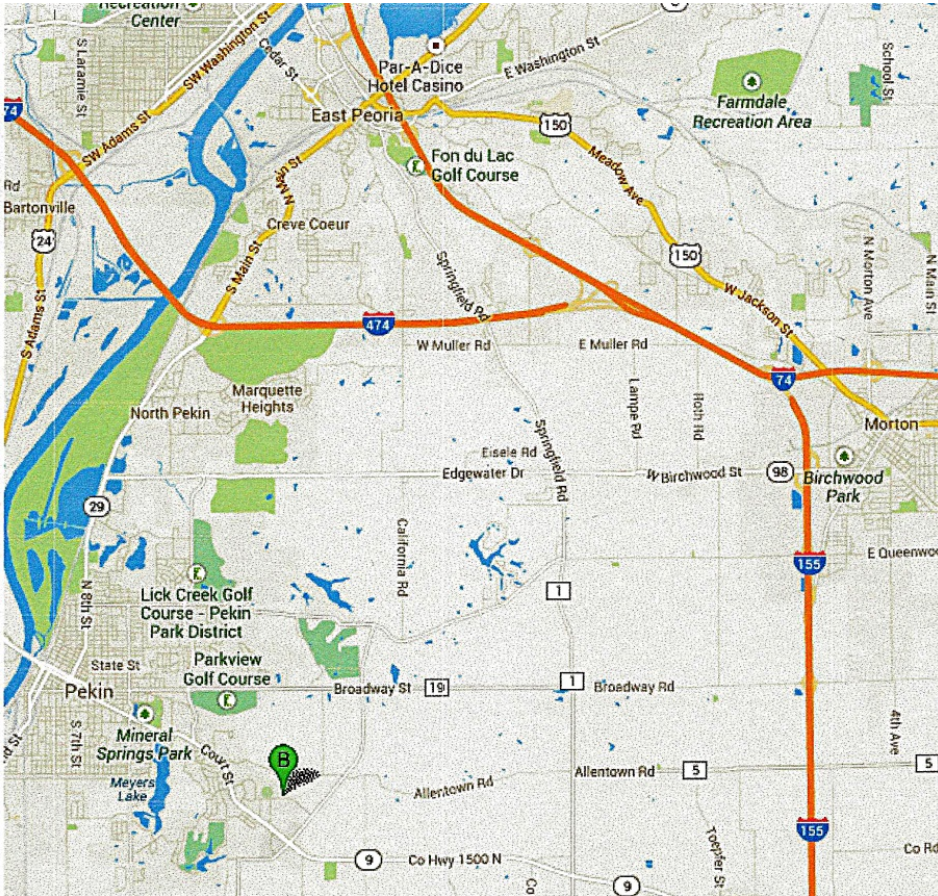

**PLEASE CHECK WITH IL IDOT FOR ROAD CONSTRUCTION ISSUES**

There is road construction around the exits into Morton. At this time, traffic is moving freely through without any blockages.

*Official Show Photographer*  
*PawPrintPictures*  
*www.PawPrintPictures.com*  
*847-431-4681*

|                       |                    |
|-----------------------|--------------------|
| <b>Name of Club</b>   | <b>Date</b>        |
| <b>Breed</b>          | <b>Sex</b>         |
| <b>Dog's AKC Name</b> | <b>Dog's AKC #</b> |

| Move Entry to:              |      |           |        | Jump Height Division: (Circle One) |     |     |     |     |     |
|-----------------------------|------|-----------|--------|------------------------------------|-----|-----|-----|-----|-----|
| Agility Class: (Circle One) |      |           |        |                                    |     |     |     |     |     |
| Regular Standard            | Open | Excellent | Master | 8"                                 | 12" | 16" | 20" | 24" | 26" |
| Regular JWW                 | Open | Excellent | Master | 8"                                 | 12" | 16" | 20" | 24" | 26" |
| Regular FAST                | Open | Excellent | Master | 8"                                 | 12" | 16" | 20" | 24" | 26" |
| Preferred Standard          | Open | Excellent | Master | 4"                                 | 8"  | 12" | 16" | 20" |     |
| Preferred JWW               | Open | Excellent | Master | 4"                                 | 8"  | 12" | 16" | 20" |     |
| Preferred FAST              | Open | Excellent | Master | 4"                                 | 8"  | 12" | 16" | 20" |     |

**Owners Name:** \_\_\_\_\_

**Handlers Name:** \_\_\_\_\_  
(If applicable)

**Signature of owner or agent**  
**duly authorized to make this entry:** \_\_\_\_\_

**Signature of Trial Secretary**  
**If Approved:** \_\_\_\_\_ **Date:** \_\_\_\_\_

**Time Received:** \_\_\_\_\_

# VOLUNTEER SIGN-UP SHEET - POTC

**POTC Bucks will be given to all volunteers! We are giving \$1, \$2, \$5 and \$10 coupons away for each class you help with!**

We want to keep things running smoothly so everyone enjoys the trials. If you are willing to assist, please fill out the form below and return it with your entry. Volunteer duties will not interfere with running your dog. Experienced timers, scribes and gate stewards, please volunteer. Training will be provided for those who are inexperienced at their assigned jobs. We will provide lunch to all volunteers. We may need additional workers on Friday because many of our members are working. We would appreciate all the help you could give us. THANKS FROM THE POTC AGILITY TRIAL COMMITTEE!

Please contact Peggy Mooney at [mmmooney65@gmail.com](mailto:mmmooney65@gmail.com) or call 309-267-3405 if you have questions about volunteering.

| Check | Job                 | Day Entered |          |        |
|-------|---------------------|-------------|----------|--------|
|       | Scribe              | Friday      | Saturday | Sunday |
|       | Timer               | Friday      | Saturday | Sunday |
|       | Gate Steward        | Friday      | Saturday | Sunday |
|       | Course Builder      | Friday      | Saturday | Sunday |
|       | Bar Setter          | Friday      | Saturday | Sunday |
|       | Leash Runner        | Friday      | Saturday | Sunday |
|       | Scribe Sheet Runner | Friday      | Saturday | Sunday |

I am running in the following classes:

| Level     | # Dogs | Jump Height | Friday | Saturday | Sunday |
|-----------|--------|-------------|--------|----------|--------|
| Novice    |        |             |        |          |        |
| Open      |        |             |        |          |        |
| Excellent |        |             |        |          |        |
| Master    |        |             |        |          |        |

Your Name: \_\_\_\_\_

Phone Number \_\_\_\_\_

Email Address \_\_\_\_\_

**PLEASE ENCLOSE THIS FORM WITH YOUR ENTRY AND WRITE "WORKER" ON THE LOWER LEFT SIDE OF ENVELOPE OR EMAIL PEGGY BEFORE TRIAL TO GET ON SCHEDULE.**

**Thank you so much for volunteering.**



OFFICIAL AMERICAN KENNEL CLUB AGILITY ENTRY FORM

Peoria Obedience Training Club

Opens: June 17, 2016 • Closes: August 26, 2016

Sept 9, 10, 11, 2016 STD JWW FAST T2B PremSTD PremJWW

Table with dates 9/9/2016, 9/10/2016, 9/11/2016 and columns for class types: STD, JWW, FAST, T2B, PremSTD, PremJWW.

Daily Entry Fee: 1st run \$25; \$15 each additional run

Make checks payable to: POTC

Mail to: Le Hayes, 10800 W Brimfield-Jubilee Rd, Princeville, IL 61559

IMPORTANT: Carefully read instructions before filling out! ENTRY FEE ENCLOSED

Choose Either Regular OR Preferred Classes

Circle one jump height | Circle class selections | Only one selection per class (both Master & Premier allowed)

Table with columns for REGULAR Classes (8", 12", 16", 20", 24", 26") and PREFERRED Classes (4", 8", 12", 16", 20"). Rows include STD, JWW, FAST, T2B with sub-classifications like NovA, NovB, Open, Exc, Master, Premier.

Non-Regular Classes International Sweepstakes  STD  JWW

ISC Jump Height Select:  14"  18"  26" or  Jump Height Same as Regular/Preferred

Form fields: This Dog Needs To Be Measured (Yes/No), SEX, HEIGHT AT WITHERS, BREED, VARIETY, CALL NAME.

AKC® NAME (INCLUDE AKC TITLES ONLY)

Form fields: AKC® NO, PAL NO, FOREIGN REG. NO & COUNTRY, BREEDER, DATE OF BIRTH, PLACE OF BIRTH (LIST COUNTRY).

SIRE

DAM

ACTUAL OWNERS

OWNERS ADDRESS  NEW ADDRESS

CITY, STATE ZIP + 4

HANDLER ENTER JR. HANDLER # if applicable

Exhibitor or owner MUST sign on the signature line beneath the instructions.

AKC Rules, Regulations, Policies and Guidelines are available on the American Kennel Club Web site, www.akc.org.

AGREEMENT

I certify that I am the actual owner of the dog, or that I am the duly authorized agent of the actual owner whose name I have entered. In consideration of the acceptance of this entry, I (we) agree to abide by the rules and regulations of The American Kennel Club in effect at the time of this event, and any additional rules and regulations appearing in the premium list of this event and entry form and any decision made in accord with them. I (we) agree that the club holding this event has the right to refuse this entry for cause which the club shall deem sufficient. I (we) certify and represent that the dog entered is not a hazard to persons or other dogs. In consideration of the acceptance of this entry and of the holding of this event and of the opportunity to have the dog judged and to win prizes, ribbons, or trophies, I (we) agree to hold the AKC, the event-giving club, their members, directors, governors, officers, agents, superintendents or event secretary and the owner and/or lessor of the premises and any provider of services that are necessary to hold this event and any employees or volunteers of the aforementioned parties, and any AKC approved judge, judging at this event, harmless from any claim for loss or injury which may be alleged to have been caused directly or indirectly to any person or thing by the act of this dog while in or about the event premises or grounds or near any entrance thereto, and I (we) personally assume all responsibility and liability for any such claim; and I (we) further agree to hold the aforementioned parties harmless from any claim for loss, injury or damage to this dog. Additionally, I (we) hereby assume the sole responsibility for and agree to indemnify, defend and save the aforementioned parties harmless from any and all loss and expense (including legal fees) by reason of the liability imposed by law upon any of the aforementioned parties for damage because of bodily injuries, including death at any time resulting therefrom, sustained by any person or persons, including myself (ourselves), or on account of damage to property, arising out of or in consequence of my (our) participation in this event, however such, injuries, death or property damage may be caused, and whether or not the same may have been caused or may be alleged to have been caused by the negligence of the aforementioned parties or any of their employees, agents, or any other person. I (we) agree that the determination of whether the injury is serious shall be made by the event veterinarian and is binding on me (us).

I (WE) AGREE THAT ANY CAUSE OF ACTION, CONTROVERSY OR CLAIM ARISING OUT OF OR RELATED TO THE ENTRY, EXHIBITION OR ATTENDANCE AT THE EVENT BETWEEN THE AKC AND THE EVENT-GIVING CLUB (UNLESS OTHERWISE STATED IN THIS PREMIUM LIST) AND MYSELF (OURSELVES) OR AS TO THE CONSTRUCTION, INTERPRETATION AND EFFECT OF THIS AGREEMENT SHALL BE SETTLED BY ARBITRATION PURSUANT TO THE APPLICABLE RULES OF THE AMERICAN ARBITRATION ASSOCIATION. HOWEVER, PRIOR TO ARBITRATION ALL APPLICABLE AKC BYLAWS, RULES, REGULATIONS AND PROCEDURES MUST FIRST BE FOLLOWED AS SET FORTH IN THE AKC CHARTER AND BYLAWS, RULES, REGULATIONS, PUBLISHED POLICIES AND GUIDELINES.

INSTRUCTIONS

Handlers may opt to enter in a higher height division for all Regular titling classes, but not in a division lower than their proper height division. Dogs entered in the Preferred classes must compete at the required jump height and may not compete in a jump height division higher or lower than their proper height division.

All dogs that have not been officially measured for an Agility Jump Height Card may still compete; however, they must be measured by a Judge of record, an Agility Field Representative, or a Volunteer Measuring Official, prior to running. If measured by the Judge of record, that measurement will be valid for this trial or back-to-back trials only. If a measurement is necessary, it is the exhibitor's responsibility to have their dog(s) measured prior to running.

Dogs listed in the AKC Canine PartnersSM program may be eligible to enter all-breed AKC agility trials at the club's option. These dogs should be listed as All American Dog and must include their AKC number on the entry form and check the AKC No. box.

Junior Handlers should enter their Junior Handler number on the front of this form. Should you not have your Junior Handler number, it may be obtained from the American Kennel Club (919) 233-9767. If the Junior Handler is not the owner of the dog identified on the face of this form, what is the relationship of the Junior Handler to the Owner? \_\_\_\_\_

SIGNATURE of owner or his agent duly authorized to make this entry.

SIGN HERE X \_\_\_\_\_

Telephone Number: \_\_\_\_\_

Email Address: \_\_\_\_\_  New Email

In Case of Emergency - Name: \_\_\_\_\_ Phone #: \_\_\_\_\_